

# Installing your Built-in Oven

## Bringing it all together

### Provision for Ventilation

The appliance housing used must provide adequate ventilation.

For built-in installation, a minimum ventilation space of 85 – 90mm x 40mm must exist between the rear of the appliance and the back of the housing or an adjacent wall.

If a tall housing is to be installed flush with the ceiling, a 20cm<sup>2</sup> ventilation cut-out must be provided at the top of the housing.

### Electrical connection

Important: Electrical connections must be carried out by a suitable qualified person and in accordance with all relevant local building and installation regulations.

#### Fitting on a Power Supply Cable

Connecting appropriate power supply to the terminal board/connector block:

#### Opening the terminal board/connector block (refer to diagram 2):

Using the flat head of a screwdriver, unhook/unlatch the plastic cover of the terminal board by unlatching 2 points, A and B, (Please refer to diagram 2). From here you will be able to open the plastic cover from the terminal board

#### To install the cable, proceed as follows (refer to diagram 3):

Remove the wire clamp screw and the three contact screws L(4), N(5),  $\perp$

Fasten the wires beneath the screw heads using the following color scheme :Blue (N) Brown (L) Yellow-Green  $\perp$  .Fasten the supply cable in place with the clamp and close the cover of the terminal board.

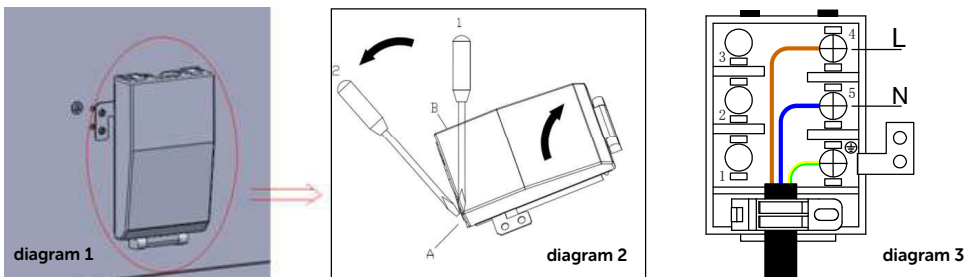

**Warning:** Connections must be in accordance with the relevant local building and installation regulations.

#### Connecting the supply cable to the mains

Install an approved circuit breaker with a minimum contact opening of 3 mm, between the appliance and the mains fuse box. The circuit breaker should be sized according to the load and should comply with current regulations (the earth wire should not be interrupted by the circuit breaker).

The supply cable should be positioned so that it does not reach a temperature of more than 50°C with respect to the room temperature, anywhere along its length. Before switching fuse ON in meter-box check:

- Earth continuity. The electrical safety of this appliance can only be guaranteed if the cooker is correctly installed and earthed, in compliance with regulations on electrical installations.
- The electrical capacity of the system and sockets will support the maximum power of the appliance, as indicated on the data plate.